

DM SERIES

DIMENSIONS (Unless otherwise specified, a tolerance of ±0.4 mm applies to all dimensions.)

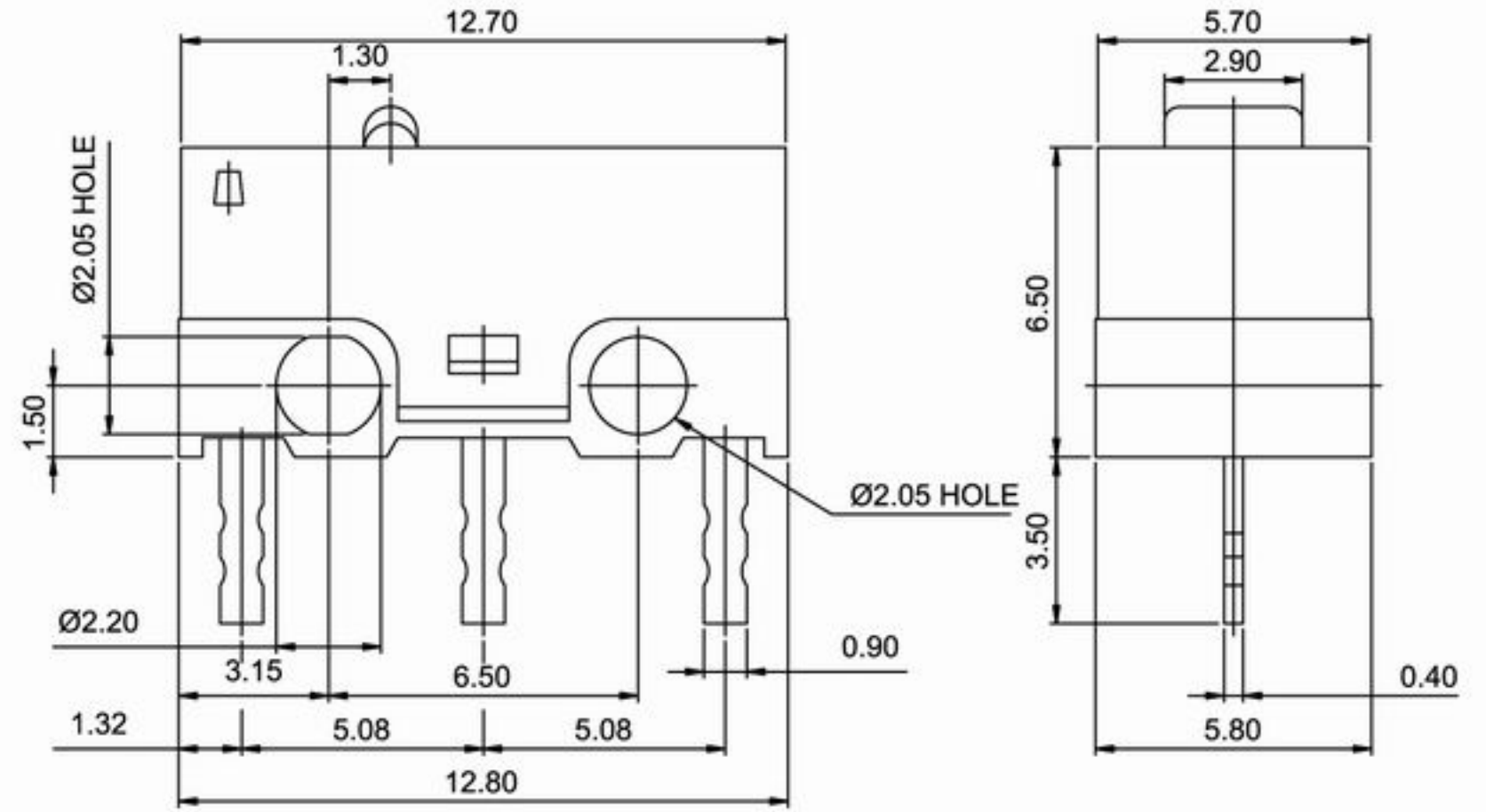
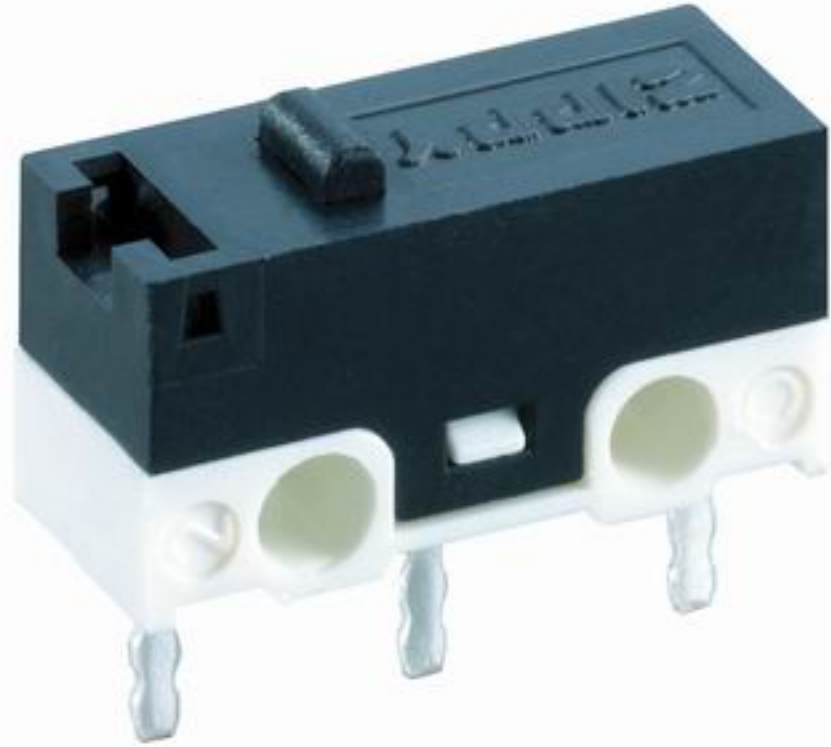

SPECIFICATIONS

- Contact Resistance (initial).....Max. 100mΩ
- Insulation Resistance (at 500VDC/minute).....Min. 100MΩ
- Dielectric Strength.....1000VAC (50~60Hz)
- Storage Temperature Range.....-25°C to 85°C
- Storage Humidity.....at 40°C, Max. 85% R.H
- Operating Temperature range0°C to 65°C
- Vibration.....10~55Hz, displacement 0.75mm (p-p)
- Electrical Service Life.....0.1A, 0.2A- Min. 1,000,000 operations
3A - Min. 10,000 operations
- Electrical Operating Frequency....0.1A- 120 operations per minute
3A- 10~30 operations per minute
- Mechanical Service Life.....Min. 1,000,000 operations
- Mechanical Operating Frequency.....120 operations per minute

CONTACT CONFIGURATION

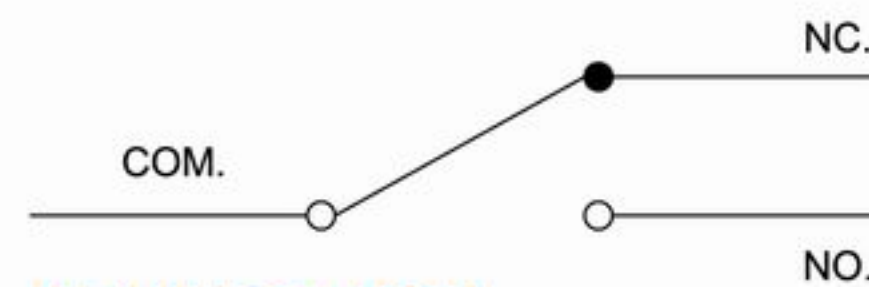

APPLICATION

Walkie talkie, Mouse, Electric knife, Electric stapler, telephone, calculator, Mixer & Chopper, Electric pan, Battery charger, Video cassette rewinder, Cordless phone, tester machine.

MOUNTING HOLES

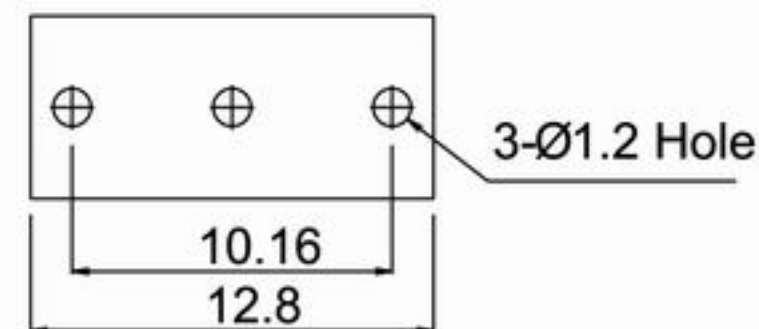

CERTIFICATE INFORMATION

| Model Name | UL, cUL | CSA | ENEC14 |
|------------|---|--|--------------------|
| DM-03 | 0.1/1A/3A 125VAC(Temp:65°C) 0.1A/0.2A 48VDC/60VDC Min. 6,000 operations | 1A/3A 125VAC 0.1A 48VDC/125VAC Min. 6,000 operations | 1A/3A 125VAC,u 1E4 |

THE SELECTION OF RATING & FORCE

| Model | Rating | L | S |
|-------|--------------|---|---|
| DM | 0.1A 0.2A | * | * |
| | 3A | * | * |

TERMINAL TYPES

PCB TERMINAL

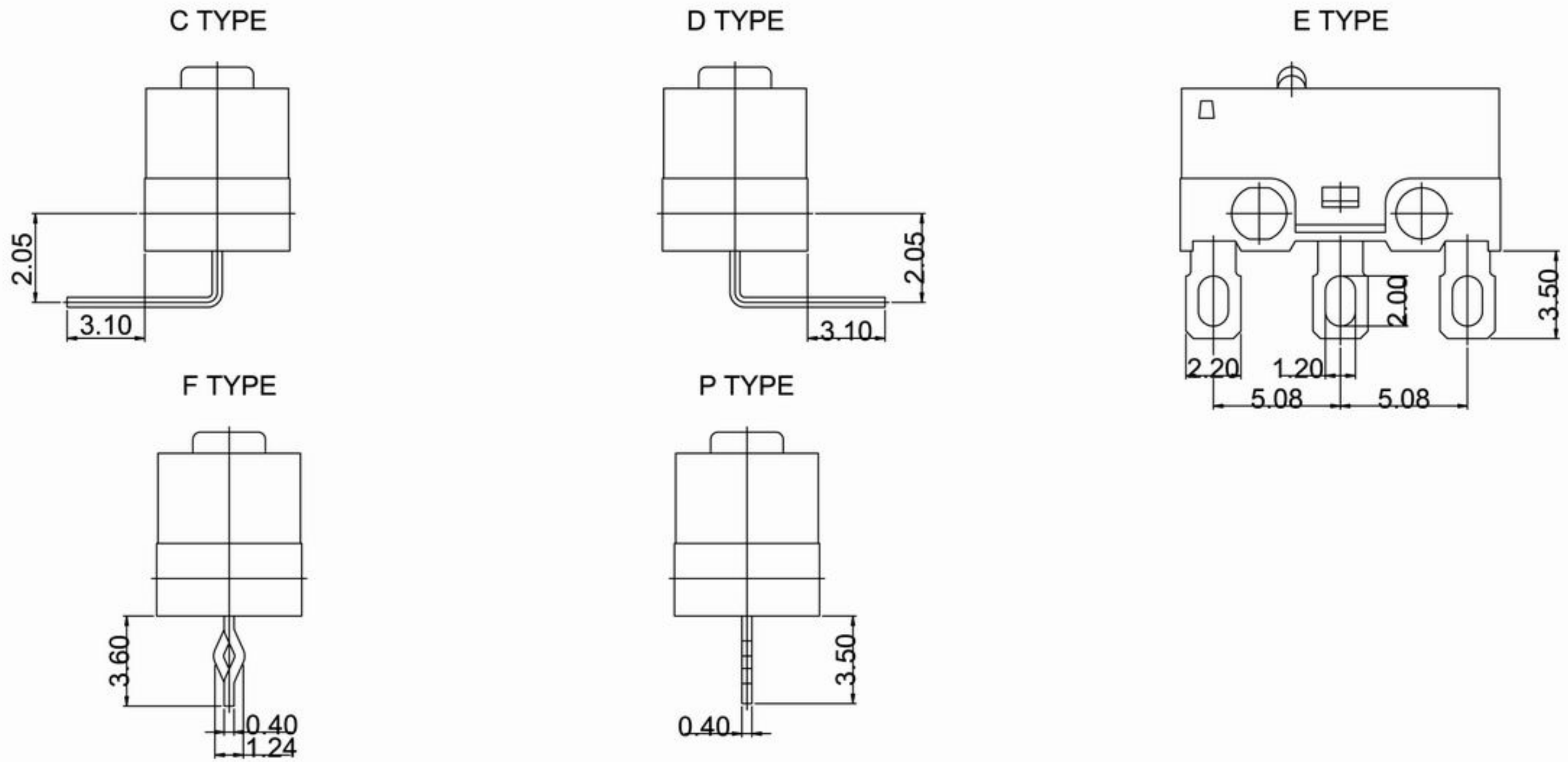

ORDERING INFORMATION

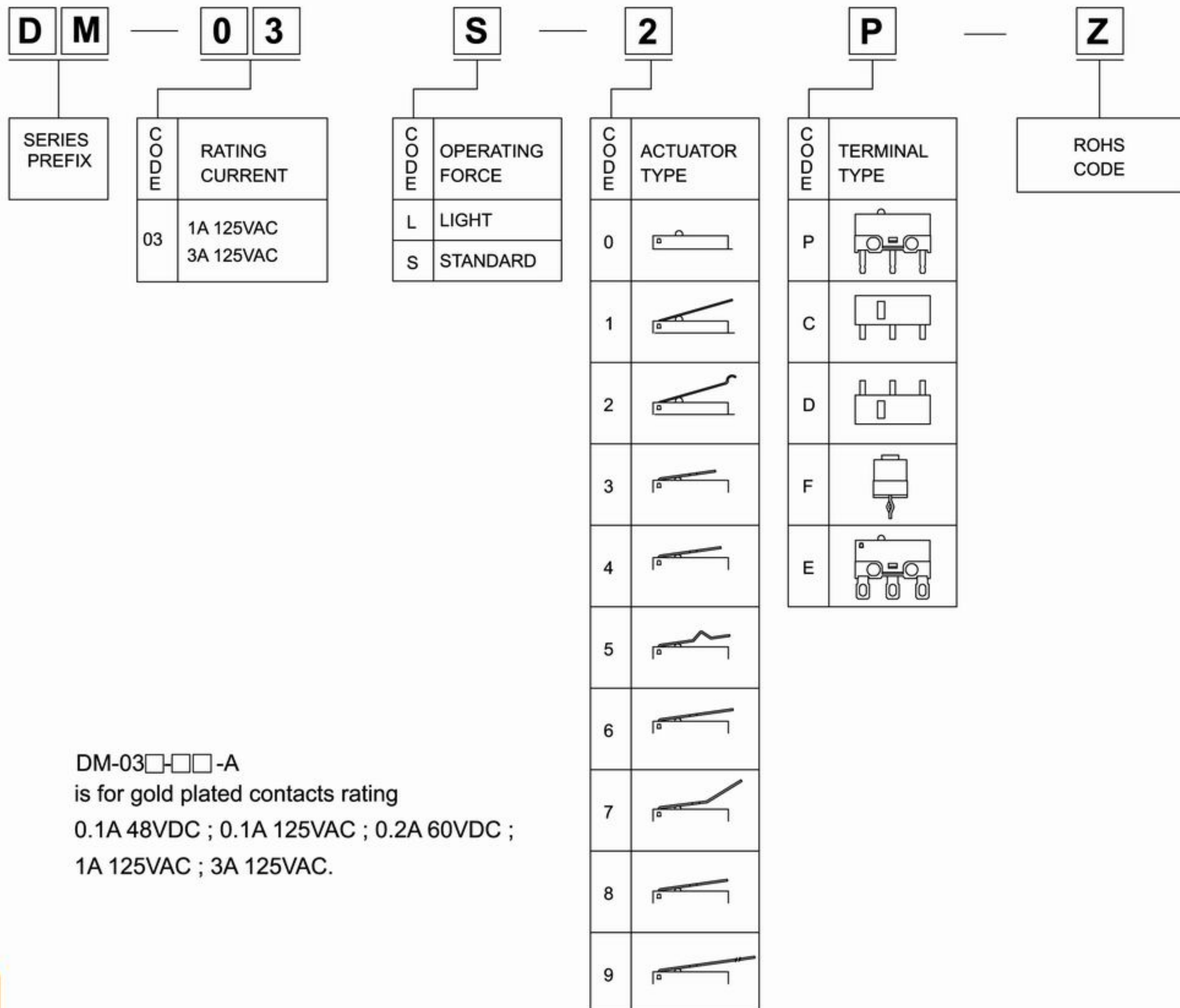

ORDERING CHARACTERISTICS

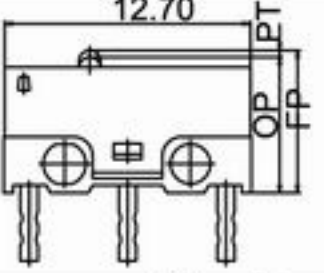
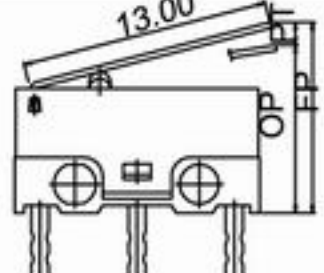
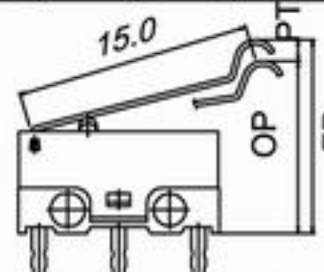
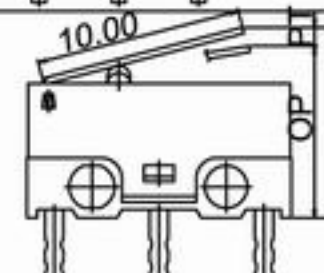
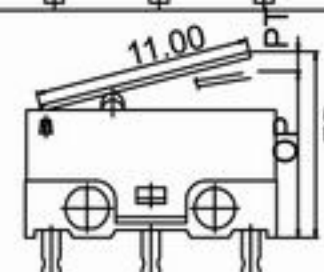
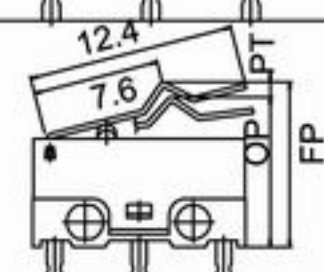
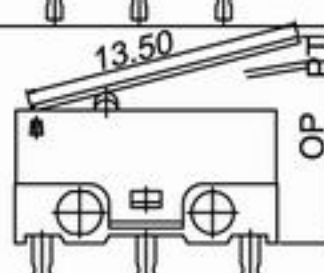
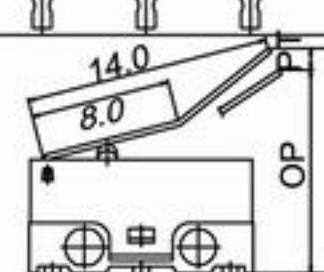
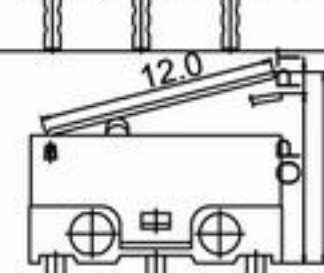
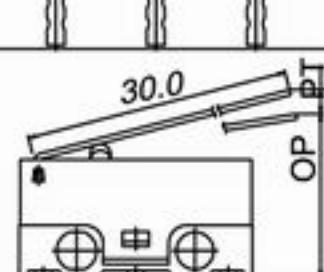
| SWITCH TYPE | PART SUFFIX | OF MAX. (gf) | OP (mm) | PT Max. (mm) | OT Min. (mm) | MD Max. (mm) | FP Max. (mm) | RF Min. (gf) |
|-------------|---|--------------|---------|--------------|--------------|--------------|--------------|--------------|
| DM-03□-0□-Z |  | L | 90 | 7.0±0.3 | 1.3 | 0.2 | 0.3 | 15 |
| | | S | 150 | | | | | 20 |
| DM-03□-1□-Z |  | L | 30 | 8.4±0.8 | 3.4 | 0.6 | 1.3 | 5 |
| | | S | 50 | | | | | 8 |
| DM-03□-2□-Z |  | L | 27 | 10.5±0.8 | 3.8 | 0.6 | 1.5 | 4 |
| | | S | 45 | | | | | 7 |
| DM-03□-3□-Z |  | L | 40 | 7.9±0.8 | 3.4 | 0.6 | 1.0 | 6 |
| | | S | 70 | | | | | 10 |
| DM-03□-4□-Z |  | L | 36 | 8.1±0.8 | 3.4 | 0.6 | 1.1 | 5 |
| | | S | 65 | | | | | 9 |
| DM-03□-5□-Z |  | L | 53 | 8.9±0.8 | 2.9 | 0.6 | 0.8 | 8 |
| | | S | 88 | | | | | 12 |
| DM-03□-6□-Z |  | L | 29 | 8.5±0.8 | 3.5 | 0.7 | 1.4 | 4 |
| | | S | 50 | | | | | 7 |
| DM-03□-7□-Z |  | L | 29 | 11.3±1.0 | 3.7 | 0.3 | 1.4 | 4 |
| | | S | 50 | | | | | 7 |
| DM-03□-8□-Z |  | L | 33 | 8.2±0.8 | 3.4 | 0.5 | 1.2 | 5 |
| | | S | 60 | | | | | 8 |
| DM-03□-9□-Z |  | L | 15 | 10.79±2.1 | 10.1 | 0.9 | 3.0 | 2 |
| | | S | 22 | 8.9±2.1 | | | | 3 |